

**REPLACEMENT PARTS**  
MA-580-PL



# Marlow Series 580<sup>®</sup> In-Line Centrifugal Pumps

REPLACEMENT PARTS

 **GOULDS**  
WATER TECHNOLOGY  
a xylem brand

# Index



How To Use This Parts List .....3

Exploded Parts View –  
Standard Seal Configuration.....4

Size 1½ x 1½ x 7B Pump Parts.....5

Size 1½ x 1½ x 9½ Pump Parts .....6

Size 2 x 2 x 7 Pump Parts .....7

Size 2 x 2 x 9½B Pump Parts.....8

Size 2½ x 2½ x 7 Pump Parts .....9

Size 2½ x 2½ x 9½B Pump Parts.....10

Size 3 x 3 x 7B Pump Parts.....11

Size 3 x 3 x 9½B Pump Parts.....12

Size 3 x 3 x 11 Pump Parts .....13

Size 4 x 4 x 7 Pump Parts .....14

Size 4 x 4 x 9½ Pump Parts .....15

Size 4 x 4 x 11 Pump Parts .....16

Size 5 x 5 x 7 Pump Parts .....17

Size 5 x 5 x 9½ Pump Parts .....18

Size 6 x 6 x 7 Pump Parts .....19

Size 6 x 6 x 9½ Pump Parts .....20

Size 6 x 6 x 11 Pump Parts .....21

Size 8 x 8 x 9½ Pump Parts .....22

Size 8 x 8 x 11 Pump Parts .....23

# How to use this PARTS LIST

The pump nameplate identifies the pump by pipe size, seal configuration, pump construction and impeller diameter as shown below.

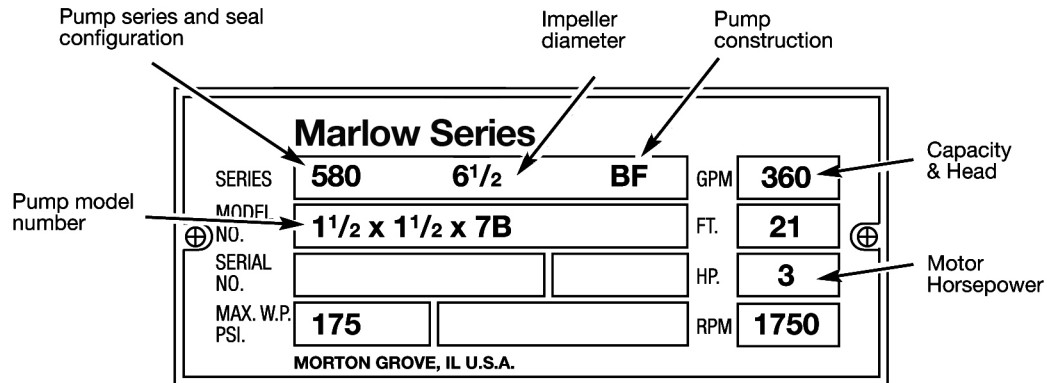

The nameplate identifies the pump in the example as a Series 580 with Bronze Fitted (BF) construction. The pump is listed in the parts list by its maximum impeller diameter and would be called a 1 1/2 x 1 1/2 x 7 pump. The actual impeller size for the example pump is 6 1/2" as shown above.

The Series 580 pump is furnished with both "Standard Seal" or "Standard Seal" with flush line construction. The "Standard Seal" pump has no seal designation after the Series Number in the nameplate; if the example pump were of the "Standard Seal" with flush line construction then the nameplate would show it to be an 580-F 6 1/2 BF pump.

The motor shaft size, depending on motor horsepower, may be either 1 1/4" or 1 5/8" in diameter. The shaft size is measured at the point where the shaft enters the volute coverplate and affects the selection of the seal, shaft sleeve, water slinger and volute coverplate as indicated in the parts list.

Following the procedure below will result in proper parts selection:

1. Determine from the nameplate the pump size, seal configuration, pump construction and impeller diameter.
2. Measure shaft diameter.
3. Refer to the index for the page number of the parts list for the pump involved.
4. Find the proper column in the parts list for the pump construction involved.
5. Select part numbers, using the drawing on page 5 for identification. Where shaft diameter affects parts selection, use the measurement secured in step 2.
6. Motor brackets vary with motor frame sizes. Secure the motor frame number from the motor nameplate and use to select the proper motor bracket. Always give complete motor nameplate data when ordering replacement motors.

# Series 580 Pump

STANDARD SEAL  
CONSTRUCTION

## Exploded View

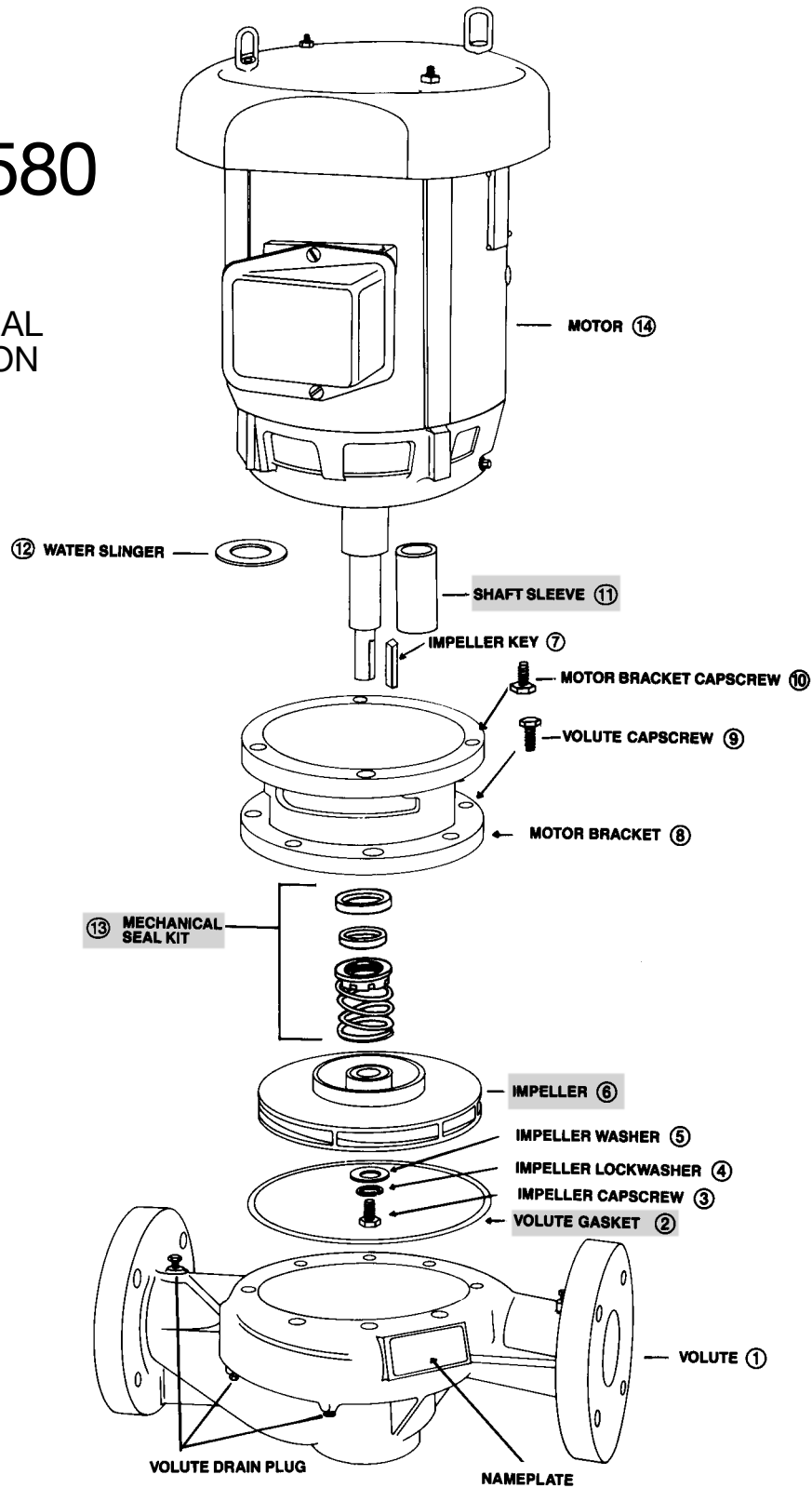

# 1<sup>1</sup>/<sub>2</sub> x 1<sup>1</sup>/<sub>2</sub> x 7B Pumps

ITEM NO.	DESCRIPTION	PUMP CONSTRUCTION			
		ALL IRON	BRONZE FITTED		
			STANDARD	W/WEAR RING	W/EPT SEAL

## PARTS COMMON TO BOTH TYPES

6	Impeller (State Diameter)	P85560	P2000600	P2000600	P2000600
3	Impeller Capscrew	P52350	P52350	P52350	P52350
4	Impeller Lockwasher	J23874	J23874	J23874	J23874
5	Impeller Washer	P46381	P46390	P46390	P46390
7	Impeller Key	P49369	P49369	P49369	P49369
1	Volute	P85304	P85304	*P85600	P85304
	Wear Ring	—	—	P46700	—
	Volute Drain Plug 1/4" (5)	P39050	P39040	P39040	P39040
9	Volute Capscrew (8)	P40020	P40020	P40020	P40020
2	Volute Gasket	P57700	P57700	P57700	P57700
12	Water Slinger	P53550	P53550	P53550	P53550

## PARTS FOR STANDARD SEAL CONSTRUCTION

8	Motor Bracket — Motor Frames 143JM-145JM, 182JM-184JM	186526	186526	186526	186526
8	Motor Bracket — F Construction Motor Frames 143JM-145JM, 182JM-184JM	—	P90523	P90523	P90523
10	Motor Bracket Capscrew for Above (4)	P40020	P40020	P40020	P40020
8	Motor Bracket — Motor Frames 213JM-215JM	186528	186528	186528	186528
8	Motor Bracket — F Construction Motor Frames 213JM-215JM	—	P90524	P90524	P90524
13	Seal Kit	186860	186862LF	186862LF	186861LF
11	Shaft Sleeve Kit	185025	185024LF	185024LF	185024LF

— Factory recommended spare parts.

\*Includes Wear Ring

# 1<sup>1</sup>/<sub>2</sub> x 1<sup>1</sup>/<sub>2</sub> x 9<sup>1</sup>/<sub>2</sub> Pumps

ITEM NO.	DESCRIPTION	PUMP CONSTRUCTION			
		ALL IRON	BRONZE FITTED		
			STANDARD	W/WEAR RING	W/EPT SEAL

## PARTS COMMON TO BOTH TYPES

6	Impeller (State Diameter) 1 <sup>1</sup> / <sub>4</sub> " Shaft	P85561	P2000601	P2000601	P2000601
6	Impeller (State Diameter) 1 <sup>5</sup> / <sub>8</sub> " Shaft	P85567	P2000602	P2000602	P2000602
3	Impeller Capscrew 1 <sup>1</sup> / <sub>4</sub> " Shaft	P52350	P52350	P52350	P52350
3	Impeller Capscrew 1 <sup>5</sup> / <sub>8</sub> " Shaft	P13800	P13800	P13800	P13800
4	Impeller Lockwasher 1 <sup>1</sup> / <sub>4</sub> " Shaft	J23874	J23874	J23874	J23874
4	Impeller Lockwasher 1 <sup>5</sup> / <sub>8</sub> " Shaft	J23875	J23875	J23875	J23875
5	Impeller Washer 1 <sup>1</sup> / <sub>4</sub> " Shaft	P46381	P46390	P46390	P46390
5	Impeller Washer 1 <sup>5</sup> / <sub>8</sub> " Shaft	P46382	P51250	P51250	P51250
7	Impeller Key 1 <sup>1</sup> / <sub>4</sub> " Shaft	P49369	P49369	P49369	P49369
7	Impeller Key 1 <sup>5</sup> / <sub>8</sub> " Shaft	P49372	P49372	P49372	P49372
1	Volute	P85354	P85354	*P85602	P85354
	Wear Ring	—	—	P46700	—
	Volute Drain Plug 1/4" (5)	P39050	P39040	P39040	P39040
9	Volute Capscrew (12)	P03470	P03470	P03470	P03470
2	Volute Gasket	P48690	P48690	P48690	P48690
12	Water Slinger 1 <sup>1</sup> / <sub>4</sub> " Shaft	P53550	P53550	P53550	P53550

## PARTS FOR STANDARD SEAL CONSTRUCTION

8	Motor Bracket — Motor Frames 143JM-145JM, 182JM-184JM	186533	186533	186533	186533
8	Motor Bracket — F Construction Motor Frames 143JM-145JM, 182JM-184JM	—	P90527	P90527	P90527
10	Motor Bracket Capscrew for Above (4)	P40020	P40020	P40020	P40020
8	Motor Bracket — Motor Frames 213JM-215JM	186530	186530	186530	186530
8	Motor Bracket — F Construction Motor Frames 213JM-215JM	—	P90528	P90528	P90528
10	Motor Bracket Capscrew for Above (4)	K03600	K03600	K03600	K03600
8	Motor Bracket — Motor Frames 254JP-256JP	P77166	P77166	P77166	P77166
8	Motor Bracket — F Construction Motor Frames 254JP-256JP	—	P90529	P90529	P90529
10	Motor Bracket Capscrew for Above (4)	P13780	P13780	P13780	P13780
8	Motor Bracket — Motor Frames 284JP-286JP	P53500	P53500	P53500	P53500
8	Motor Bracket — F Construction Motor Frames 284JP-286JP	—	P90530	P90530	P90530
10	Motor Bracket Capscrew for Above (4)	P19490	P19490	P19490	P19490
13	Seal Kit 1 <sup>1</sup> / <sub>4</sub> " Shaft	186860	186862LF	186862LF	186861LF
13	Seal Kit 1 <sup>5</sup> / <sub>8</sub> " Shaft	186544	186543LF	186543LF	185225LF
11	Shaft Sleeve Kit 1 <sup>1</sup> / <sub>4</sub> " Shaft	185025	185024LF	185024LF	185024LF
11	Shaft Sleeve Kit 1 <sup>5</sup> / <sub>8</sub> " Shaft	185022	185021LF	185021LF	185021LF
12	Water Slinger 1 <sup>5</sup> / <sub>8</sub> " Shaft	P53720	P53720	P53720	P53720

NOTE: 1<sup>1</sup>/<sub>4</sub>" Shaft — up to and including Motor Frame 215JM. 1<sup>5</sup>/<sub>8</sub>" Shaft — Motor Frame 213JP and larger. \*Includes Wear Ring  
 ■ — Factory recommended spare parts.

# 2 x 2 x 7 Pumps

ITEM NO.	DESCRIPTION	PUMP CONSTRUCTION			
		ALL IRON	BRONZE FITTED		
			STANDARD	W/WEAR RING	W/EPT SEAL

## PARTS COMMON TO BOTH TYPES

6	Impeller (State Diameter) 1 <sup>1</sup> / <sub>4</sub> " Shaft	P85411	P2000598	P2000598	P2000598
6	Impeller (State Diameter) 1 <sup>5</sup> / <sub>8</sub> " Shaft	P85433	P2000599	P2000599	P2000599
3	Impeller Capscrew 1 <sup>1</sup> / <sub>4</sub> " Shaft	P52350	P52350	P52350	P52350
3	Impeller Capscrew 1 <sup>5</sup> / <sub>8</sub> " Shaft	P13800	P13800	P13800	P13800
4	Impeller Lockwasher 1 <sup>1</sup> / <sub>4</sub> " Shaft	J23874	J23874	J23874	J23874
4	Impeller Lockwasher 1 <sup>5</sup> / <sub>8</sub> " Shaft	J23875	J23875	J23875	J23875
5	Impeller Washer 1 <sup>1</sup> / <sub>4</sub> " Shaft	P46381	P46390	P46390	P46390
5	Impeller Washer 1 <sup>5</sup> / <sub>8</sub> " Shaft	P46382	P51250	P51250	P51250
7	Impeller Key 1 <sup>1</sup> / <sub>4</sub> " Shaft	P49369	P49369	P49369	P49369
7	Impeller Key 1 <sup>5</sup> / <sub>8</sub> " Shaft	P49372	P49372	P49372	P49372
1	Volute	P85311	P85311	*P85614	P85311
	Wear Ring	—	—	P48660	—
	Volute Drain Plug 1/4" (5)	P39050	P39040	P39040	P39040
2	Volute Gasket	P57700	P57700	P57700	P57700
12	Water Slinger 1 <sup>1</sup> / <sub>4</sub> " Shaft	P53550	P53550	P53550	P53550

## PARTS FOR STANDARD SEAL CONSTRUCTION

8	Motor Bracket — Motor Frames 143JM-145JM, 182JM-184JM	186526	186526	186526	186526
8	Motor Bracket — F Construction Motor Frames 143JM-145JM, 182JM-184JM	—	P90523	P90523	P90523
10	Motor Bracket Capscrew for Above (4)	P40020	P40020	P40020	P40020
8	Motor Bracket — Motor Frames 213JM-215JM	186528	186528	186528	186528
8	Motor Bracket — F Construction Motor Frames 213JM-215JM	—	P90524	P90524	P90524
10	Motor Bracket Capscrew for Above (4)	K03600	K03600	K03600	K03600
8	Motor Bracket — Motor Frames 254JP	P77076	P77076	P77076	P77076
8	Motor Bracket — F Construction Motor Frame 254JP	—	P90525	P90525	P90525
10	Motor Bracket Capscrew for Above (4)	P13780	P13780	P13780	P13780
9	Volute Capscrew (8)	P40020	P40020	P40020	P40020
13	Seal Kit 1 <sup>1</sup> / <sub>4</sub> " Shaft	186860	186862LF	186862LF	186861LF
13	Seal Kit 1 <sup>5</sup> / <sub>8</sub> " Shaft	186544	186543LF	186543LF	185225LF
11	Shaft Sleeve Kit 1 <sup>1</sup> / <sub>4</sub> " Shaft	185025	185024LF	185024LF	185024LF
11	Shaft Sleeve Kit 1 <sup>5</sup> / <sub>8</sub> " Shaft	185022	185021LF	185021LF	185021LF
12	Water Slinger 1 <sup>5</sup> / <sub>8</sub> " Shaft	P53720	P53720	P53720	P53720

NOTE: 1<sup>1</sup>/<sub>4</sub>" Shaft — up to and including Motor Frame 215JM. 1<sup>5</sup>/<sub>8</sub>" Shaft — Motor Frame 213JP and larger. \*Includes Wear Ring

— Factory recommended spare parts.

# 2 x 2 x 9<sup>1</sup>/<sub>2</sub>B Pumps

ITEM NO.	DESCRIPTION	PUMP CONSTRUCTION			
		ALL IRON	BRONZE FITTED		
			STANDARD	W/WEAR RING	W/EPT SEAL

## PARTS COMMON TO BOTH TYPES

6	Impeller (State Diameter) 1 <sup>1</sup> / <sub>4</sub> " Shaft	P85563	P2000605	P2000605	P2000605
6	Impeller (State Diameter) 1 <sup>5</sup> / <sub>8</sub> " Shaft	P85569	P2000606	P2000606	P2000606
3	Impeller Capscrew 1 <sup>1</sup> / <sub>4</sub> " Shaft	P52350	P52350	P52350	P52350
3	Impeller Capscrew 1 <sup>5</sup> / <sub>8</sub> " Shaft	P13800	P13800	P13800	P13800
4	Impeller Lockwasher 1 <sup>1</sup> / <sub>4</sub> " Shaft	J23874	J23874	J23874	J23874
4	Impeller Lockwasher 1 <sup>5</sup> / <sub>8</sub> " Shaft	J23875	J23875	J23875	J23875
5	Impeller Washer 1 <sup>1</sup> / <sub>4</sub> " Shaft	P46381	P46390	P46390	P46390
5	Impeller Washer 1 <sup>5</sup> / <sub>8</sub> " Shaft	P46382	P51250	P51250	P51250
7	Impeller Key 1 <sup>1</sup> / <sub>4</sub> " Shaft	P49369	P49369	P49369	P49369
7	Impeller Key 1 <sup>5</sup> / <sub>8</sub> " Shaft	P49372	P49372	P49372	P49372
1	Volute	P85344	P85344	*P85622	P85344
	Wear Ring	—	—	P49130	—
	Volute Drain Plug 1/4" (5)	P39050	P39040	P39040	P39040
9	Volute Capscrew (12)	P03470	P03470	P03470	P03470
2	Volute Gasket	P48690	P48690	P48690	P48690
12	Water Slinger 1 <sup>1</sup> / <sub>4</sub> " Shaft	P53550	P53550	P53550	P53550

## PARTS FOR STANDARD SEAL CONSTRUCTION

8	Motor Bracket — Motor Frames 143JM-145JM, 182JM-184JM	186533	186533	186533	186533
8	Motor Bracket — F Construction Motor Frames 143JM-145JM, 182JM-184JM	—	P90527	P90527	P90527
10	Motor Bracket Capscrew for Above (4)	P40020	P40020	P40020	P40020
8	Motor Bracket — Motor Frames 213JM-215JM	186530	186530	186530	186530
8	Motor Bracket — F Construction Motor Frames 213JM-215JM	—	P90528	P90528	P90528
10	Motor Bracket Capscrew for Above (4)	K03600	K03600	K03600	K03600
8	Motor Bracket — Motor Frames 254JP-256JP	P77166	P77166	P77166	P77166
8	Motor Bracket — F Construction Motor Frames 254JP-256JP	—	P90529	P90529	P90529
10	Motor Bracket Capscrew for Above (4)	P13780	P13780	P13780	P13780
8	Motor Bracket — Motor Frames 284JP-286JP	P53500	P53500	P53500	P53500
8	Motor Bracket — F Construction Motor Frames 284JP-286JP	—	P90530	P90530	P90530
10	Motor Bracket Capscrew for Above (4)	P19490	P19490	P19490	P19490
13	Seal Kit 1 <sup>1</sup> / <sub>4</sub> " Shaft	186860	186862LF	186862LF	186861LF
13	Seal Kit 1 <sup>5</sup> / <sub>8</sub> " Shaft	186544	186543LF	186543LF	185225LF
11	Shaft Sleeve Kit 1 <sup>1</sup> / <sub>4</sub> " Shaft	185025	185024LF	185024LF	185024LF
11	Shaft Sleeve Kit 1 <sup>5</sup> / <sub>8</sub> " Shaft	185022	185021LF	185021LF	185021LF
12	Water Slinger 1 <sup>5</sup> / <sub>8</sub> " Shaft	P53720	P53720	P53720	P53720

NOTE: 1<sup>1</sup>/<sub>4</sub>" Shaft — up to and including Motor Frame 215JM. 1<sup>5</sup>/<sub>8</sub>" Shaft — Motor Frame 213JP and larger. \*Includes Wear Ring

— Factory recommended spare parts.

# 2<sup>1</sup>/<sub>2</sub> x 2<sup>1</sup>/<sub>2</sub> x 7 Pumps

ITEM NO.	DESCRIPTION	PUMP CONSTRUCTION			
		ALL IRON	BRONZE FITTED		
			STANDARD	W/WEAR RING	W/EPT SEAL

## PARTS COMMON TO BOTH TYPES

6	Impeller (State Diameter) 1 <sup>1</sup> / <sub>4</sub> " Shaft	P85562	P2000603	P2000603	P2000603
6	Impeller (State Diameter) 1 <sup>5</sup> / <sub>8</sub> " Shaft	P85568	P2000604	P2000604	P2000604
3	Impeller Capscrew 1 <sup>1</sup> / <sub>4</sub> " Shaft	P52350	P52350	P52350	P52350
3	Impeller Capscrew 1 <sup>5</sup> / <sub>8</sub> " Shaft	P13800	P13800	P13800	P13800
4	Impeller Lockwasher 1 <sup>1</sup> / <sub>4</sub> " Shaft	J23874	J23874	J23874	J23874
4	Impeller Lockwasher 1 <sup>5</sup> / <sub>8</sub> " Shaft	J23875	J23875	J23875	J23875
5	Impeller Washer 1 <sup>1</sup> / <sub>4</sub> " Shaft	P46381	P46390	P46390	P46390
5	Impeller Washer 1 <sup>5</sup> / <sub>8</sub> " Shaft	P46382	P51250	P51250	P51250
7	Impeller Key 1 <sup>1</sup> / <sub>4</sub> " Shaft	P49369	P49369	P49369	P49369
7	Impeller Key 1 <sup>5</sup> / <sub>8</sub> " Shaft	P49372	P49372	P49372	P49372
1	Volute	P85314	P85314	*P85604	P85314
	Wear Ring	—	—	P49145	—
	Volute Drain Plug 1 <sup>1</sup> / <sub>4</sub> " (5)	P39050	P39040	P39040	P39040
2	Volute Gasket	P57700	P57700	P57700	P57700
12	Water Slinger 1 <sup>1</sup> / <sub>4</sub> " Shaft	P53550	P53550	P53550	P53550

## PARTS FOR STANDARD SEAL CONSTRUCTION

8	Motor Bracket — Motor Frames 143JM-145JM, 182JM-184JM	186526	186526	186526	186526
8	Motor Bracket — F Construction Motor Frames 143JM-145JM, 182JM-184JM	—	P90523	P90523	P90523
10	Motor Bracket Capscrew for Above (4)	P40020	P40020	P40020	P40020
8	Motor Bracket — Motor Frames 213JM-215JM	186528	186528	186528	186528
8	Motor Bracket — F Construction Motor Frames 213JM-215JM	—	P90524	P90524	P90524
10	Motor Bracket Capscrew for Above (4)	K03600	K03600	K03600	K03600
8	Motor Bracket — Motor Frames 254JP-256JP	P77066	P77066	P77066	P77066
8	Motor Bracket — F Construction Motor Frames 254JP-256JP	—	P90525	P90525	P90525
10	Motor Bracket Capscrew for Above (4)	P13780	P13780	P13780	P13780
9	Volute Capscrew (8)	P40020	P40020	P40020	P40020
13	Seal Kit 1 <sup>1</sup> / <sub>4</sub> " Shaft	186860	186862LF	186862LF	186861LF
13	Seal Kit 1 <sup>5</sup> / <sub>8</sub> " Shaft	186544	186543LF	186543LF	185225LF
11	Shaft Sleeve Kit 1 <sup>1</sup> / <sub>4</sub> " Shaft	185025	185024LF	185024LF	185024LF
11	Shaft Sleeve Kit 1 <sup>5</sup> / <sub>8</sub> " Shaft	185022	185021LF	185021LF	185021LF
12	Water Slinger 1 <sup>5</sup> / <sub>8</sub> " Shaft	P53720	P53720	P53720	P53720

NOTE: 1<sup>1</sup>/<sub>4</sub>" Shaft — up to and including Motor Frame 215JM. 1<sup>5</sup>/<sub>8</sub>" Shaft — Motor Frame 213JP and larger. \*Includes Wear Ring  
 ■ — Factory recommended spare parts.

# 2<sup>1</sup>/<sub>2</sub> x 2<sup>1</sup>/<sub>2</sub> x 9<sup>1</sup>/<sub>2</sub>B Pumps

ITEM NO.	DESCRIPTION	PUMP CONSTRUCTION			
		ALL IRON	BRONZE FITTED		
			STANDARD	W/WEAR RING	W/EPT SEAL

## PARTS COMMON TO BOTH TYPES

6	Impeller (State Diameter) 1 <sup>1</sup> / <sub>4</sub> " Shaft	P85563	P2000605	P2000605	P2000605
6	Impeller (State Diameter) 1 <sup>5</sup> / <sub>8</sub> " Shaft	P85569	P2000606	P2000606	P2000606
3	Impeller Capscrew 1 <sup>1</sup> / <sub>4</sub> " Shaft	P52350	P52350	P52350	P52350
3	Impeller Capscrew 1 <sup>5</sup> / <sub>8</sub> " Shaft	P13800	P13800	P13800	P13800
4	Impeller Lockwasher 1 <sup>1</sup> / <sub>4</sub> " Shaft	J23874	J23874	J23874	J23874
4	Impeller Lockwasher 1 <sup>5</sup> / <sub>8</sub> " Shaft	J23875	J23875	J23875	J23875
5	Impeller Washer 1 <sup>1</sup> / <sub>4</sub> " Shaft	P46381	P46390	P46390	P46390
5	Impeller Washer 1 <sup>5</sup> / <sub>8</sub> " Shaft	P46382	P51250	P51250	P51250
7	Impeller Key 1 <sup>1</sup> / <sub>4</sub> " Shaft	P49369	P49369	P49369	P49369
7	Impeller Key 1 <sup>5</sup> / <sub>8</sub> " Shaft	P49372	P49372	P49372	P49372
1	Volute	P85358	P85358	*P85606	P85358
	Wear Ring	—	—	P49130	—
	Volute Drain Plug 1/4" (5)	P39050	P39040	P39040	P39040
9	Volute Capscrew (12)	P03470	P03470	P03470	P03470
2	Volute Gasket	P48690	P48690	P48690	P48690
12	Water Slinger 1 <sup>1</sup> / <sub>4</sub> " Shaft	P53550	P53550	P53550	P53550

## PARTS FOR STANDARD SEAL CONSTRUCTION

8	Motor Bracket — Motor Frames 145JM, 182JM-184JM	186533	186533	186533	186533
8	Motor Bracket — F Construction Motor Frames 145JM, 182JM-184JM	—	P90527	P90527	P90527
10	Motor Bracket Capscrew for Above (4)	P40020	P40020	P40020	P40020
8	Motor Bracket — Motor Frames 213JM-215JM	186530	186530	186530	186530
8	Motor Bracket — F Construction Motor Frames 213JM-215JM	—	P90528	P90528	P90528
10	Motor Bracket Capscrew for Above (4)	K03600	K03600	K03600	K03600
8	Motor Bracket — Motor Frames 254JP-256JP	P77166	P77166	P77166	P77166
8	Motor Bracket — F Construction Motor Frames 254JP-256JP	—	P90529	P90529	P90529
10	Motor Bracket Capscrew for Above (4)	P13780	P13780	P13780	P13780
8	Motor Bracket — Motor Frames 284JP-286JP, 324JP-326JP	P53500	P53500	P53500	P53500
8	Motor Bracket — F Construction Motor Frames 284JP-286JP, 324JP-326JP	—	P90530	P90530	P90530
10	Motor Bracket Capscrew for Above (4)	P19490	P19490	P19490	P19490
13	Seal Kit 1 <sup>1</sup> / <sub>4</sub> " Shaft	186860	186862LF	186862LF	186861LF
13	Seal Kit 1 <sup>5</sup> / <sub>8</sub> " Shaft	186544	186543LF	186543LF	185225LF
11	Shaft Sleeve Kit 1 <sup>1</sup> / <sub>4</sub> " Shaft	185025	185024LF	185024LF	185024LF
11	Shaft Sleeve Kit 1 <sup>5</sup> / <sub>8</sub> " Shaft	185022	185021LF	185021LF	185021LF
12	Water Slinger 1 <sup>5</sup> / <sub>8</sub> " Shaft	P53720	P53720	P53720	P53720

NOTE: 1<sup>1</sup>/<sub>4</sub>" Shaft — up to and including Motor Frame 215JM. 1<sup>5</sup>/<sub>8</sub>" Shaft — Motor Frame 213JP and larger. \*Includes Wear Ring  
 — Factory recommended spare parts.

# 3 x 3 x 7B Pumps

ITEM NO.	DESCRIPTION	PUMP CONSTRUCTION			
		ALL IRON	BRONZE FITTED		
			STANDARD	W/WEAR RING	W/EPT SEAL

## PARTS COMMON TO BOTH TYPES

6	Impeller (State Diameter) 1 <sup>1</sup> / <sub>4</sub> " Shaft	P85564	P2000607	P2000607	P2000607
6	Impeller (State Diameter) 1 <sup>5</sup> / <sub>8</sub> " Shaft	P85570	P2000608	P2000608	P2000608
3	Impeller Capscrew 1 <sup>1</sup> / <sub>4</sub> " Shaft	P52350	P52350	P52350	P52350
3	Impeller Capscrew 1 <sup>5</sup> / <sub>8</sub> " Shaft	P13800	P13800	P13800	P13800
4	Impeller Lockwasher 1 <sup>1</sup> / <sub>4</sub> " Shaft	J23874	J23874	J23874	J23874
4	Impeller Lockwasher 1 <sup>5</sup> / <sub>8</sub> " Shaft	J23875	J23875	J23875	J23875
5	Impeller Washer 1 <sup>1</sup> / <sub>4</sub> " Shaft	P46381	P46390	P46390	P46390
5	Impeller Washer 1 <sup>5</sup> / <sub>8</sub> " Shaft	P46382	P51250	P51250	P51250
7	Impeller Key 1 <sup>1</sup> / <sub>4</sub> " Shaft	P49369	P49369	P49369	P49369
7	Impeller Key 1 <sup>5</sup> / <sub>8</sub> " Shaft	P49372	P49372	P49372	P49372
1	Volute	P85324	P85324	*P85608	P85324
	Wear Ring	—	—	P85399	—
	Volute Drain Plug 1/4" (5)	P39050	P39040	P39040	P39040
2	Volute Gasket	P57700	P57700	P57700	P57700
12	Water Slinger 1 <sup>1</sup> / <sub>4</sub> " Shaft	P53550	P53550	P53550	P53550

## PARTS FOR STANDARD SEAL CONSTRUCTION

8	Motor Bracket — Motor Frames 143JM-145JM, 182JM-184JM	186526	186526	186526	186526
8	Motor Bracket — F Construction Motor Frames 143JM-145JM, 182JM-184JM	—	P90523	P90523	P90523
10	Motor Bracket Capscrew for Above (4)	P40020	P40020	P40020	P40020
8	Motor Bracket — Motor Frames 213JM-215JM	186528	186528	186528	186528
8	Motor Bracket — F Construction Motor Frames 213JM-215JM	—	P90524	P90524	P90524
10	Motor Bracket Capscrew for Above (4)	K03600	K03600	K03600	K03600
8	Motor Bracket — Motor Frames 254JP-256JP	P77076	P77076	P77076	P77076
8	Motor Bracket — F Construction Motor Frames 254JP-256JP	—	P90525	P90525	P90525
10	Motor Bracket Capscrew for Above (4)	P13780	P13780	P13780	P13780
9	Volute Capscrew (8)	P40020	P40020	P40020	P40020
13	Seal Kit 1 <sup>1</sup> / <sub>4</sub> " Shaft	186860	186862LF	186862LF	186861LF
13	Seal Kit 1 <sup>5</sup> / <sub>8</sub> " Shaft	186544	186543LF	186543LF	185225LF
11	Shaft Sleeve Kit 1 <sup>1</sup> / <sub>4</sub> " Shaft	185025	185024LF	185024LF	185024LF
11	Shaft Sleeve Kit 1 <sup>5</sup> / <sub>8</sub> " Shaft	185022	185021LF	185021LF	185021LF
12	Water Slinger 1 <sup>5</sup> / <sub>8</sub> " Shaft	P53720	P53720	P53720	P53720

NOTE: 1<sup>1</sup>/<sub>4</sub>" Shaft — up to and including Motor Frame 215JM. 1<sup>5</sup>/<sub>8</sub>" Shaft — Motor Frame 213JP and larger. \*Includes Wear Ring  
 — Factory recommended spare parts.

# 3 x 3 x 9<sup>1</sup>/<sub>2</sub>B Pumps

ITEM NO.	DESCRIPTION	PUMP CONSTRUCTION			
		ALL IRON	BRONZE FITTED		
			STANDARD	W/WEAR RING	W/EPT SEAL

## PARTS COMMON TO BOTH TYPES

6	Impeller (State Diameter) 1 <sup>1</sup> / <sub>4</sub> " Shaft	P85565	P2000609	P2000609	P2000609
6	Impeller (State Diameter) 1 <sup>5</sup> / <sub>8</sub> " Shaft	P85571	P2000610	P2000610	P2000610
3	Impeller Capscrew 1 <sup>1</sup> / <sub>4</sub> " Shaft	P52350	P52350	P52350	P52350
3	Impeller Capscrew 1 <sup>5</sup> / <sub>8</sub> " Shaft	P13800	P13800	P13800	P13800
4	Impeller Lockwasher 1 <sup>1</sup> / <sub>4</sub> " Shaft	J23874	J23874	J23874	J23874
4	Impeller Lockwasher 1 <sup>5</sup> / <sub>8</sub> " Shaft	J23875	J23875	J23875	J23875
5	Impeller Washer 1 <sup>1</sup> / <sub>4</sub> " Shaft	P46381	P46390	P46390	P46390
5	Impeller Washer 1 <sup>5</sup> / <sub>8</sub> " Shaft	P46382	P51250	P51250	P51250
7	Impeller Key 1 <sup>1</sup> / <sub>4</sub> " Shaft	P49369	P49369	P49369	P49369
7	Impeller Key 1 <sup>5</sup> / <sub>8</sub> " Shaft	P49372	P49372	P49372	P49372
1	Volute	P85364	P85364	*P85610	P85364
	Wear Ring	—	—	P49870	—
	Volute Drain Plug 1/4" (5)	P39050	P39040	P39040	P39040
9	Volute Capscrew (12)	P03470	P03470	P03470	P03470
2	Volute Gasket	P48690	P48690	P48690	P48690
12	Water Slinger 1 <sup>1</sup> / <sub>4</sub> " Shaft	P53550	P53550	P53550	P53550

## PARTS FOR STANDARD SEAL CONSTRUCTION

8	Motor Bracket — Motor Frame 184JM	186533	186533	186533	186533
8	Motor Bracket — F Construction Motor Frame 184JM	—	P90527	P90527	P90527
10	Motor Bracket Capscrew for Above (4)	P40020	P40020	P40020	P40020
8	Motor Bracket — Motor Frames 213JM-215JM	186530	186530	186530	186530
8	Motor Bracket — F Construction Motor Frames 213JM-215JM	—	P90528	P90528	P90528
10	Motor Bracket Capscrew for Above (4)	K03600	K03600	K03600	K03600
8	Motor Bracket — Motor Frames 254JP-256JP	P77166	P77166	P77166	P77166
8	Motor Bracket — F Construction Motor Frames 254JP-256JP	—	P90529	P90529	P90529
10	Motor Bracket Capscrew for Above (4)	P13780	P13780	P13780	P13780
8	Motor Bracket — Motor Frames 284JP-286JP, 324JP-326JP	P53500	P53500	P53500	P53500
8	Motor Bracket — F Construction Motor Frames 284JP-286JP, 324JP-326JP	—	P90530	P90530	P90530
10	Motor Bracket Capscrew for Above (4)	P19490	P19490	P19490	P19490
13	Seal Kit 1 <sup>1</sup> / <sub>4</sub> " Shaft	186860	186862LF	186862LF	186861LF
13	Seal Kit 1 <sup>5</sup> / <sub>8</sub> " Shaft	186544	186543LF	186543LF	185225LF
11	Shaft Sleeve Kit 1 <sup>1</sup> / <sub>4</sub> " Shaft	185025	185024LF	185024LF	185024LF
11	Shaft Sleeve Kit 1 <sup>5</sup> / <sub>8</sub> " Shaft	185022	185021LF	185021LF	185021LF
12	Water Slinger 1 <sup>5</sup> / <sub>8</sub> " Shaft	P53720	P53720	P53720	P53720

NOTE: 1<sup>1</sup>/<sub>4</sub>" Shaft — up to and including Motor Frame 215JM. 1<sup>5</sup>/<sub>8</sub>" Shaft — Motor Frame 213JP and larger. \*Includes Wear Ring

— Factory recommended spare parts.

# 3 x 3 x 11 Pumps

ITEM NO.	DESCRIPTION	PUMP CONSTRUCTION			
		ALL IRON	BRONZE FITTED		
			STANDARD	W/WEAR RING	W/EPT SEAL

## PARTS COMMON TO BOTH TYPES

6	Impeller (State Diameter) 1/4" Shaft	P50197	P2000620	→	→
6	Impeller (State Diameter) 1/8" Shaft	P50206	P2000625	→	→
3	Impeller Capscrew 1/4" Shaft	P52350	→	→	→
3	Impeller Capscrew 1/8" Shaft	P13800	→	→	→
4	Impeller Lockwasher 1/4" Shaft	J23874	→	→	→
4	Impeller Lockwasher 1/8" Shaft	J23875	→	→	→
5	Impeller Washer 1/4" Shaft	P46381	P46390	→	→
5	Impeller Washer 1/8" Shaft	P46382	P51250	→	→
7	Impeller Key 1/4" Shaft	P49369	→	→	→
7	Impeller Key 1/8" Shaft	P49372	→	→	→
1	Volute	P85647	→	*P82963	P85647
	Wear Ring	—	—	P49870	→
	Volute Drain Plug 1/4" (5)	P39050	P39040	→	→
9	Volute Capscrew (16)	P13780	→	→	→
2	Volute Gasket	P80765	→	→	→
12	Water Slinger 1/4" Shaft	P53550	→	→	→

## PARTS FOR STANDARD SEAL CONSTRUCTION

8	Motor Bracket — Motor Frames 213JM-215JM	P53026	→	→	→
8	Motor Bracket — F Construction Motor Frames 213JM-215JM	—	P90532	→	→
10	Motor Bracket Capscrew for Above (4)	K03600	→	→	→
8	Motor Bracket — Motor Frames 254JP-256JP	P53032	→	→	→
8	Motor Bracket — Motor Frames 284JP-286JP & 324JP-326JP	P53036	→	→	→
8	Motor Bracket — F Construction Motor Frames 254JP-256JP	—	P90533	→	→
8	Motor Bracket — F Construction Motor Frames 284JP, 286JP, 324JP & 326JP	—	P90534	→	→
10	Motor Bracket Capscrew for Above (4)	P13780	→	→	→
13	Seal Kit 1/4" Shaft	186860	186862LF	→	186861LF
13	Seal Kit 1/8" Shaft	186544	186543LF	→	185225LF
11	Shaft Sleeve Kit 1/4" Shaft	185025	185024LF	→	→
11	Shaft Sleeve Kit 1/8" Shaft	185022	185021LF	→	→
12	Water Slinger 1/8" Shaft	P53720	→	→	→

NOTE: 1/4" Shaft — up to and including Motor Frame 215JM. 1/8" Shaft — Motor Frame 213JP and larger. \*Includes Wear Ring  
 ■ — Factory recommended spare parts.

# 4 x 4 x 7 Pumps

ITEM NO.	DESCRIPTION	PUMP CONSTRUCTION			
		ALL IRON	BRONZE FITTED		
			STANDARD	W/WEAR RING	W/EPT SEAL

## PARTS COMMON TO BOTH TYPES

6	Impeller (State Diameter) 1/4" Shaft	P85417	P2000628	P2000628	P2000628
6	Impeller (State Diameter) 1/8" Shaft	P85439	P2000626	P2000626	P2000626
3	Impeller Capscrew 1/4" Shaft	P52350	P52350	P52350	P52350
3	Impeller Capscrew 1/8" Shaft	P13800	P13800	P13800	P13800
4	Impeller Lockwasher 1/4" Shaft	J23874	J23874	J23874	J23874
4	Impeller Lockwasher 1/8" Shaft	J23875	J23875	J23875	J23875
5	Impeller Washer 1/4" Shaft	P46381	P46390	P46390	P46390
5	Impeller Washer 1/8" Shaft	P46382	P51250	P51250	P51250
7	Impeller Key 1/4" Shaft	P49369	P49369	P49369	P49369
7	Impeller Key 1/8" Shaft	P49372	P49372	P49372	P49372
1	Volute	P85331	P85331	*P85616	P85331
	Wear Ring	—	—	P85397	—
	Volute Drain Plug 1/4" (5)	P39050	P39040	P39040	P39040
2	Volute Gasket	P57700	P57700	P57700	P57700
12	Water Slinger 1/4" Shaft	P53550	P53550	P53550	P53550

## PARTS FOR STANDARD SEAL CONSTRUCTION

8	Motor Bracket — Motor Frames 143JM, 182JM-184JM	186526	186526	186526	186526
8	Motor Bracket — F Construction Motor Frames 145JM, 182JM-184JM	—	P90523	P90523	P90523
10	Motor Bracket Capscrew for Above (4)	P40020	P40020	P40020	P40020
8	Motor Bracket — Motor Frames 213JM-215JM	186528	186528	186528	186528
8	Motor Bracket — F Construction Motor Frames 213JM-215JM	—	P90524	P90524	P90524
10	Motor Bracket Capscrew for Above (4)	K03600	K03600	K03600	K03600
8	Motor Bracket — Motor Frames 254JP-256JP	P77166	P77166	P77166	P77166
8	Motor Bracket — F Construction Motor Frames 254JP-256JP	—	P90525	P90525	P90525
10	Motor Bracket Capscrew for Above (4)	P13780	P13780	P13780	P13780
8	Motor Bracket — Motor Frames 284JP-286JP	P53880	P53880	P53880	P53880
8	Motor Bracket — F Construction Motor Frames 284JP-286JP	—	P90526	P90526	P90526
10	Motor Bracket Capscrew for Above (4)	P19490	P19490	P19490	P19490
9	Volute Capscrew (8)	P40020	P40020	P40020	P40020
13	Seal Kit 1/4" Shaft	186860	186862LF	186862LF	186861LF
13	Seal Kit 1/8" Shaft	186544	186543LF	186543LF	185225LF
11	Shaft Sleeve Kit 1/4" Shaft	185025	185024LF	185024LF	185024LF
11	Shaft Sleeve Kit 1/8" Shaft	185022	185021LF	185021LF	185021LF
12	Water Slinger 1/8" Shaft	P53720	P53720	P53720	P53720

NOTE: 1/4" Shaft — up to and including Motor Frame 215JM. 1/8" Shaft — Motor Frame 213JP and larger. \*Includes Wear Ring

— Factory recommended spare parts.

# 4 x 4 x 9<sup>1</sup>/<sub>2</sub> Pumps

ITEM NO.	DESCRIPTION	PUMP CONSTRUCTION			
		ALL IRON	BRONZE FITTED		
			STANDARD	W/WEAR RING	W/EPT SEAL

## PARTS COMMON TO BOTH TYPES

6	Impeller (State Diameter) 1 <sup>1</sup> / <sub>4</sub> " Shaft	P85454	P2000627	P2000627	P2000627
6	Impeller (State Diameter) 1 <sup>5</sup> / <sub>8</sub> " Shaft	P85455	P2000629	P2000629	P2000629
3	Impeller Capscrew 1 <sup>1</sup> / <sub>4</sub> " Shaft	P52350	P52350	P52350	P52350
3	Impeller Capscrew 1 <sup>5</sup> / <sub>8</sub> " Shaft	P13800	P13800	P13800	P13800
4	Impeller Lockwasher 1 <sup>1</sup> / <sub>4</sub> " Shaft	J23874	J23874	J23874	J23874
4	Impeller Lockwasher 1 <sup>5</sup> / <sub>8</sub> " Shaft	J23875	J23875	J23875	J23875
5	Impeller Washer 1 <sup>1</sup> / <sub>4</sub> " Shaft	P46381	P46390	P46390	P46390
5	Impeller Washer 1 <sup>5</sup> / <sub>8</sub> " Shaft	P46382	P51250	P51250	P51250
7	Impeller Key 1 <sup>1</sup> / <sub>4</sub> " Shaft	P49369	P49369	P49369	P49369
7	Impeller Key 1 <sup>5</sup> / <sub>8</sub> " Shaft	P49372	P49372	P49372	P49372
1	Volute	P85371	P85371	*P85620	P85371
	Wear Ring	—	—	P85401	—
	Volute Drain Plug 1 <sup>1</sup> / <sub>4</sub> " (5)	P39050	P39040	P39040	P39040
9	Volute Capscrew (12)	P03470	P03470	P03470	P03470
2	Volute Gasket	P48690	P48690	P48690	P48690
12	Water Slinger 1 <sup>1</sup> / <sub>4</sub> " Shaft	P53550	P53550	P53550	P53550

## PARTS FOR STANDARD SEAL CONSTRUCTION

8	Motor Bracket — Motor Frames 213JM-215JM	186530	186530	186530	186530
8	Motor Bracket — F Construction Motor Frames 213JM-215JM	—	P90528	P90528	P90528
10	Motor Bracket Capscrew for Above (4)	K03600	K03600	K03600	K03600
8	Motor Bracket — Motor Frames 254JP-256JP	P77166	P77166	P77166	P77166
8	Motor Bracket — F Construction Motor Frames 254JP-256JP	—	P90529	P90529	P90529
10	Motor Bracket Capscrew for Above (4)	P13780	P13780	P13780	P13780
13	Seal Kit 1 <sup>1</sup> / <sub>4</sub> " Shaft	186860	186862LF	186862LF	186861LF
13	Seal Kit 1 <sup>5</sup> / <sub>8</sub> " Shaft	186544	186543LF	186543LF	185225LF
11	Shaft Sleeve Kit 1 <sup>1</sup> / <sub>4</sub> " Shaft	185025	185024LF	185024LF	185024LF
11	Shaft Sleeve Kit 1 <sup>5</sup> / <sub>8</sub> " Shaft	185022	185021LF	185021LF	185021LF
12	Water Slinger 1 <sup>5</sup> / <sub>8</sub> " Shaft	P53720	P53720	P53720	P53720

NOTE: 1<sup>1</sup>/<sub>4</sub>" Shaft — up to and including Motor Frame 215JM. 1<sup>5</sup>/<sub>8</sub>" Shaft — Motor Frame 213JP and larger. \*Includes Wear Ring

— Factory recommended spare parts.

# 4 x 4 x 11 Pumps

ITEM NO.	DESCRIPTION	PUMP CONSTRUCTION			
		ALL IRON	BRONZE FITTED		
			STANDARD	W/WEAR RING	W/EPT SEAL

## PARTS COMMON TO BOTH TYPES

6	Impeller (State Diameter) 1 <sup>1</sup> / <sub>4</sub> " Shaft	P50973	P2000621	P2000621	P2000621
6	Impeller (State Diameter) 1 <sup>5</sup> / <sub>8</sub> " Shaft	P50974	P2000622	P2000622	P2000622
3	Impeller Capscrew 1 <sup>1</sup> / <sub>4</sub> " Shaft	P52350	P52350	P52350	P52350
3	Impeller Capscrew 1 <sup>5</sup> / <sub>8</sub> " Shaft	P13800	P13800	P13800	P13800
4	Impeller Lockwasher 1 <sup>1</sup> / <sub>4</sub> " Shaft	J23874	J23874	J23874	J23874
4	Impeller Lockwasher 1 <sup>5</sup> / <sub>8</sub> " Shaft	J23875	J23875	J23875	J23875
5	Impeller Washer 1 <sup>1</sup> / <sub>4</sub> " Shaft	P46381	P46390	P46390	P46390
5	Impeller Washer 1 <sup>5</sup> / <sub>8</sub> " Shaft	P46382	P51250	P51250	P51250
7	Impeller Key 1 <sup>1</sup> / <sub>4</sub> " Shaft	P49369	P49369	P49369	P49369
7	Impeller Key 1 <sup>5</sup> / <sub>8</sub> " Shaft	P49372	P49372	P49372	P49372
1	Volute	P85628	P85628	*P85640	P85628
	Wear Ring	—	—	P50650	—
	Volute Drain Plug 1 <sup>1</sup> / <sub>4</sub> " (3)	P39050	P39040	P39040	P39040
9	Volute Capscrew (12)	P13780	P13780	P13780	P13780
2	Volute Gasket	P80765	P80765	P80765	P80765
12	Water Slinger 1 <sup>1</sup> / <sub>4</sub> " Shaft	P53550	P53550	P53550	P53550

## PARTS FOR STANDARD SEAL CONSTRUCTION

8	Motor Bracket — Motor Frames 182JM-184JM	P53022	P53022	P53022	P53022
8	Motor Bracket — F Construction Motor Frames 182JM-184JM	—	P90531	P90531	P90531
10	Motor Bracket Capscrew for Above (4)	P40020	P40020	P40020	P40020
8	Motor Bracket — Motor Frames 213JM-215JM	P53026	P53026	P53026	P53026
8	Motor Bracket — F Construction Motor Frames 213JM-215JM	—	P90532	P90532	P90532
10	Motor Bracket Capscrew for Above (4)	K03600	K03600	K03600	K03600
8	Motor Bracket — Motor Frames 254JP-256JP	P53032	P53032	P53032	P53032
8	Motor Bracket — F Construction Motor Frames 254JP-256JP	—	P90533	P90533	P90533
10	Motor Bracket Capscrew for Above (4)	P13780	P13780	P13780	P13780
13	Seal Kit 1 <sup>1</sup> / <sub>4</sub> " Shaft	186860	186862LF	186862LF	186861LF
13	Seal Kit 1 <sup>5</sup> / <sub>8</sub> " Shaft	186544	186543LF	186543LF	185225LF
11	Shaft Sleeve Kit 1 <sup>1</sup> / <sub>4</sub> " Shaft	185025	185024LF	185024LF	185024LF
11	Shaft Sleeve Kit 1 <sup>5</sup> / <sub>8</sub> " Shaft	185022	185021LF	185021LF	185021LF
12	Water Slinger 1 <sup>5</sup> / <sub>8</sub> " Shaft	P53720	P53720	P53720	P53720

NOTE: 1<sup>1</sup>/<sub>4</sub>" Shaft — up to and including Motor Frame 215JM. 1<sup>5</sup>/<sub>8</sub>" Shaft — Motor Frame 213JP and larger. \*Includes Wear Ring  
 ■ — Factory recommended spare parts.

# 5 x 5 x 7 Pumps

ITEM NO.	DESCRIPTION	PUMP CONSTRUCTION			
		ALL IRON	BRONZE FITTED		
			STANDARD	W/WEAR RING	W/EPT SEAL

## PARTS COMMON TO BOTH TYPES

6	Impeller (State Diameter) 1/4" Shaft	P85471	P2000613	P2000613	P2000613
6	Impeller (State Diameter) 1/8" Shaft	P85473	P2000614	P2000614	P2000614
3	Impeller Capscrew 1/4" Shaft	P52350	P52350	P52350	P52350
3	Impeller Capscrew 1/8" Shaft	P13800	P13800	P13800	P13800
4	Impeller Lockwasher 1/4" Shaft	J23874	J23874	J23874	J23874
4	Impeller Lockwasher 1/8" Shaft	J23875	J23875	J23875	J23875
5	Impeller Washer 1/4" Shaft	P46381	P46390	P46390	P46390
5	Impeller Washer 1/8" Shaft	P46382	P51250	P51250	P51250
7	Impeller Key 1/4" Shaft	P49369	P49369	P49369	P49369
7	Impeller Key 1/8" Shaft	P49372	P49372	P49372	P49372
1	Volute	P85334	P85334	*P85510	P85334
	Wear Ring	—	—	P49141	—
	Volute Drain Plug 1/4" (5)	P39050	P39040	P39040	P39040
2	Volute Gasket	P57700	P57700	P57700	P57700
12	Water Slinger 1/4" Shaft	P53550	P53550	P53550	P53550

## PARTS FOR STANDARD SEAL CONSTRUCTION

8	Motor Bracket — Motor Frames 145JM, 182JM-184JM	186526	186526	186526	186526
8	Motor Bracket — F Construction Motor Frames 145JM, 182JM-184JM	—	P90523	P90523	P90523
10	Motor Bracket Capscrew for Above (4)	P40020	P40020	P40020	P40020
8	Motor Bracket — Motor Frames 213JM-215JM	186528	186528	186528	186528
8	Motor Bracket — F Construction Motor Frames 213JM-215JM	—	P90524	P90524	P90524
10	Motor Bracket Capscrew for Above (4)	K03600	K03600	K03600	K03600
8	Motor Bracket — Motor Frames 254JP-256JP	P77076	P77076	P77076	P77076
8	Motor Bracket — F Construction Motor Frames 254JP-256JP	—	P90525	P90525	P90525
10	Motor Bracket Capscrew for Above (4)	P13780	P13780	P13780	P13780
8	Motor Bracket — Motor Frames 284JP-286JP, 324JP-326JP	P53880	P53880	P53880	P53880
8	Motor Bracket — F Construction Motor Frames 284JP-286JP, 324JP-326JP	—	P90526	P90526	P90526
10	Motor Bracket Capscrew for Above (4)	P19490	P19490	P19490	P19490
9	Volute Capscrew (8)	P40020	P40020	P40020	P40020
13	Seal Kit 1/4" Shaft	186860	186862LF	186862LF	186861LF
13	Seal Kit 1/8" Shaft	186544	186543LF	186543LF	185225LF
11	Shaft Sleeve Kit 1/4" Shaft	185025	185024LF	185024LF	185024LF
11	Shaft Sleeve Kit 1/8" Shaft	185022	185021LF	185021LF	185021LF
12	Water Slinger 1/8" Shaft	P53720	P53720	P53720	P53720

NOTE: 1/4" Shaft — up to and including Motor Frame 215JM. 1/8" Shaft — Motor Frame 213JP and larger. \*Includes Wear Ring

— Factory recommended spare parts.

# 5 x 5 x 9<sup>1</sup>/<sub>2</sub> Pumps

ITEM NO.	DESCRIPTION	PUMP CONSTRUCTION			
		ALL IRON	BRONZE FITTED		
			STANDARD	W/WEAR RING	W/EPT SEAL

## PARTS COMMON TO BOTH TYPES

6	Impeller (State Diameter) 1 <sup>1</sup> / <sub>4</sub> " Shaft	P85566	P2000611	P2000611	P2000611
6	Impeller (State Diameter) 1 <sup>5</sup> / <sub>8</sub> " Shaft	P85572	P2000612	P2000612	P2000612
3	Impeller Capscrew 1 <sup>1</sup> / <sub>4</sub> " Shaft	P52350	P52350	P52350	P52350
3	Impeller Capscrew 1 <sup>5</sup> / <sub>8</sub> " Shaft	P13800	P13800	P13800	P13800
4	Impeller Lockwasher 1 <sup>1</sup> / <sub>4</sub> " Shaft	J23874	J23874	J23874	J23874
4	Impeller Lockwasher 1 <sup>5</sup> / <sub>8</sub> " Shaft	J23875	J23875	J23875	J23875
5	Impeller Washer 1 <sup>1</sup> / <sub>4</sub> " Shaft	P46381	P46390	P46390	P46390
5	Impeller Washer 1 <sup>5</sup> / <sub>8</sub> " Shaft	P46382	P51250	P51250	P51250
7	Impeller Key 1 <sup>1</sup> / <sub>4</sub> " Shaft	P49369	P49369	P49369	P49369
7	Impeller Key 1 <sup>5</sup> / <sub>8</sub> " Shaft	P49372	P49372	P49372	P49372
1	Volute	P85368	P85368	*P85612	P85368
	Wear Ring	—	—	P49142	—
	Volute Drain Plug 1 <sup>1</sup> / <sub>4</sub> " (5)	P39050	P39040	P39040	P39040
9	Volute Capscrew (12)	P03470	P03470	P03470	P03470
2	Volute Gasket	P48690	P48690	P48690	P48690
12	Water Slinger 1 <sup>1</sup> / <sub>4</sub> " Shaft	P53550	P53550	P53550	P53550

## PARTS FOR STANDARD SEAL CONSTRUCTION

8	Motor Bracket — Motor Frames 213JM-215JM	186530	186530	186530	186530
8	Motor Bracket — F Construction Motor Frames 213JM-215JM	—	P90528	P90528	P90528
10	Motor Bracket Capscrew for Above (4)	K03600	K03600	K03600	K03600
8	Motor Bracket — Motor Frames 254JP-256JP	P77166	P77166	P77166	P77166
8	Motor Bracket — F Construction Motor Frames 254JP-256JP	—	P90529	P90529	P90529
10	Motor Bracket Capscrew for Above (4)	P13780	P13780	P13780	P13780
13	Seal Kit 1 <sup>1</sup> / <sub>4</sub> " Shaft	186860	186862LF	186862LF	186861LF
13	Seal Kit 1 <sup>5</sup> / <sub>8</sub> " Shaft	186544	186543LF	186543LF	185225LF
11	Shaft Sleeve Kit 1 <sup>1</sup> / <sub>4</sub> " Shaft	185025	185024LF	185024LF	185024LF
11	Shaft Sleeve Kit 1 <sup>5</sup> / <sub>8</sub> " Shaft	185022	185021LF	185021LF	185021LF
12	Water Slinger 1 <sup>5</sup> / <sub>8</sub> " Shaft	P53720	P53720	P53720	P53720

NOTE: 1<sup>1</sup>/<sub>4</sub>" Shaft — up to and including Motor Frame 215JM. 1<sup>5</sup>/<sub>8</sub>" Shaft — Motor Frame 213JP and larger. \*Includes Wear Ring  
 ■ — Factory recommended spare parts.

# 6 x 6 x 7 Pumps

ITEM NO.	DESCRIPTION	PUMP CONSTRUCTION			
		ALL IRON	BRONZE FITTED		
			STANDARD	W/WEAR RING	W/EPT SEAL

## PARTS COMMON TO BOTH TYPES

6	Impeller (State Diameter) 1/4" Shaft	P85538	P2000615	P2000615	P2000615
6	Impeller (State Diameter) 1/8" Shaft	P85540	P2000616	P2000616	P2000616
3	Impeller Capscrew 1/4" Shaft	P52350	P52350	P52350	P52350
3	Impeller Capscrew 1/8" Shaft	P13800	P13800	P13800	P13800
4	Impeller Lockwasher 1/4" Shaft	J23874	J23874	J23874	J23874
4	Impeller Lockwasher 1/8" Shaft	J23875	J23875	J23875	J23875
5	Impeller Washer 1/4" Shaft	P46381	P46390	P46390	P46390
5	Impeller Washer 1/8" Shaft	P46382	P51250	P51250	P51250
7	Impeller Key 1/4" Shaft	P49369	P49369	P49369	P49369
7	Impeller Key 1/8" Shaft	P49372	P49372	P49372	P49372
1	Volute	P85337	P85337	*P85512	P85337
	Wear Ring	—	—	P49142	—
	Volute Drain Plug 1/4" (5)	P39050	P39040	P39040	P39040
2	Volute Gasket	P57700	P57700	P57700	P57700
12	Water Slinger 1/4" Shaft	P53550	P53550	P53550	P53550

## PARTS FOR STANDARD SEAL CONSTRUCTION

8	Motor Bracket — Motor Frames 182JM-184JM	186526	186526	186526	186526
8	Motor Bracket — F Construction Motor Frames 182JM-184JM	—	P90523	P90523	P90523
10	Motor Bracket Capscrew for Above (4)	P40020	P40020	P40020	P40020
8	Motor Bracket — Motor Frames 213JM-215JM	186528	186528	186528	186528
8	Motor Bracket — F Construction Motor Frames 213JM-215JM	—	P90524	P90524	P90524
10	Motor Bracket Capscrew for Above (4)	K03600	K03600	K03600	K03600
8	Motor Bracket — Motor Frames 254JP-256JP	P77076	P77076	P77076	P77076
8	Motor Bracket — F Construction Motor Frames 254JP-256JP	—	P90525	P90525	P90525
10	Motor Bracket Capscrew for Above (4)	P13780	P13780	P13780	P13780
8	Motor Bracket — Motor Frames 284JP-286JP, 324JP-326JP	P53880	P53880	P53880	P53880
8	Motor Bracket — F Construction Motor Frames 284JP-286JP, 324JP-326JP	—	P90526	P90526	P90526
10	Motor Bracket Capscrew for Above (4)	P19490	P19490	P19490	P19490
9	Volute Capscrew (8)	P40020	P40020	P40020	P40020
13	Seal Kit 1/4" Shaft	186860	186862LF	186862LF	186861LF
13	Seal Kit 1/8" Shaft	186544	186543LF	186543LF	185225LF
11	Shaft Sleeve Kit 1/4" Shaft	185025	185024LF	185024LF	185024LF
11	Shaft Sleeve Kit 1/8" Shaft	185022	185021LF	185021LF	185021LF
12	Water Slinger 1/8" Shaft	P53720	P53720	P53720	P53720

NOTE: 1/4" Shaft — up to and including Motor Frame 215JM. 1/8" Shaft — Motor Frame 213JP and larger. \*Includes Wear Ring  
 ■ — Factory recommended spare parts.

# 6 x 6 x 9<sup>1</sup>/<sub>2</sub> Pumps

ITEM NO.	DESCRIPTION	PUMP CONSTRUCTION			
		ALL IRON	BRONZE FITTED		
			STANDARD	W/WEAR RING	W/EPT SEAL

## PARTS COMMON TO BOTH TYPES

6	Impeller (State Diameter) 1 <sup>1</sup> / <sub>4</sub> " Shaft	P85542	P2000617	P2000617	P2000617
6	Impeller (State Diameter) 1 <sup>5</sup> / <sub>8</sub> " Shaft	P85545	P2000618	P2000618	P2000618
3	Impeller Capscrew 1 <sup>1</sup> / <sub>4</sub> " Shaft	P52350	P52350	P52350	P52350
3	Impeller Capscrew 1 <sup>5</sup> / <sub>8</sub> " Shaft	P13800	P13800	P13800	P13800
4	Impeller Lockwasher 1 <sup>1</sup> / <sub>4</sub> " Shaft	J23874	J23874	J23874	J23874
4	Impeller Lockwasher 1 <sup>5</sup> / <sub>8</sub> " Shaft	J23875	J23875	J23875	J23875
5	Impeller Washer 1 <sup>1</sup> / <sub>4</sub> " Shaft	P46381	P46390	P46390	P46390
5	Impeller Washer 1 <sup>5</sup> / <sub>8</sub> " Shaft	P46382	P51250	P51250	P51250
7	Impeller Key 1 <sup>1</sup> / <sub>4</sub> " Shaft	P49369	P49369	P49369	P49369
7	Impeller Key 1 <sup>5</sup> / <sub>8</sub> " Shaft	P49372	P49372	P49372	P49372
1	Volute	P85374	P85374	*P85514	P85374
	Wear Ring	—	—	P49143	—
	Volute Drain Plug 1 <sup>1</sup> / <sub>4</sub> " (5)	P39050	P39040	P39040	P39040
9	Volute Capscrew (12)	P03470	P03470	P03470	P03470
2	Volute Gasket	P48690	P48690	P48690	P48690
12	Water Slinger 1 <sup>1</sup> / <sub>4</sub> " Shaft	P53550	P53550	P53550	P53550

## PARTS FOR STANDARD SEAL CONSTRUCTION

8	Motor Bracket — Motor Frames 213JM-215JM	186530	186530	186530	186530
8	Motor Bracket — F Construction Motor Frames 213JM-215JM	—	P90528	P90528	P90528
10	Motor Bracket Capscrew for Above (4)	K03600	K03600	K03600	K03600
8	Motor Bracket — Motor Frames 254JM-256JM	P77166	P77166	P77166	P77166
8	Motor Bracket — F Construction Motor Frames 254JP-256JP	—	P90529	P90529	P90529
10	Motor Bracket Capscrew for Above (4)	P13780	P13780	P13780	P13780
8	Motor Bracket — Motor Frame 284JP	P53500	P53500	P53500	P53500
8	Motor Bracket — F Construction Motor Frame 284JP	—	P90530	P90530	P90530
10	Motor Bracket Capscrew for Above (4)	P19490	P19490	P19490	P19490
13	Seal Kit 1 <sup>1</sup> / <sub>4</sub> " Shaft	186860	186862LF	186862LF	186861LF
13	Seal Kit 1 <sup>5</sup> / <sub>8</sub> " Shaft	186544	186543LF	186543LF	185225LF
11	Shaft Sleeve Kit 1 <sup>1</sup> / <sub>4</sub> " Shaft	185025	185024LF	185024LF	185024LF
11	Shaft Sleeve Kit 1 <sup>5</sup> / <sub>8</sub> " Shaft	185022	185021LF	185021LF	185021LF
12	Water Slinger 1 <sup>5</sup> / <sub>8</sub> " Shaft	P53720	P53720	P53720	P53720

NOTE: 1<sup>1</sup>/<sub>4</sub>" Shaft — up to and including Motor Frame 215JM. 1<sup>5</sup>/<sub>8</sub>" Shaft — Motor Frame 213JP and larger. \*Includes Wear Ring  
 ■ — Factory recommended spare parts.

# 6 x 6 x 11 Pumps

ITEM NO.	DESCRIPTION	PUMP CONSTRUCTION			
		ALL IRON	BRONZE FITTED		
			STANDARD	W/WEAR RING	W/EPT SEAL

## PARTS COMMON TO BOTH TYPES

6	Impeller (State Diameter) 1 <sup>1</sup> / <sub>4</sub> " Shaft	P50976	P2000623	P2000623	P2000623
3	Impeller Capscrew 1 <sup>5</sup> / <sub>8</sub> " Shaft	P13800	P13800	P13800	P13800
4	Impeller Lockwasher 1 <sup>5</sup> / <sub>8</sub> " Shaft	J23875	J23875	J23875	J23875
5	Impeller Washer 1 <sup>5</sup> / <sub>8</sub> " Shaft	P46382	P51250	P51250	P51250
7	Impeller Key 1 <sup>5</sup> / <sub>8</sub> " Shaft	P49372	P49372	P49372	P49372
1	Volute	P85631	P85631	*P85641	P85631
	Wear Ring	—	—	P51390	—
	Volute Drain Plug 1 <sup>1</sup> / <sub>4</sub> " (5)	P39050	P39040	P39040	P39040
9	Volute Capscrew (16)	P13780	P13780	P13780	P13780
2	Volute Gasket	P80765	P80765	P80765	P80765

## PARTS FOR STANDARD SEAL CONSTRUCTION

8	Motor Bracket — Motor Frames 254JP-256JP	P53032	P53032	P53032	P53032
8	Motor Bracket — F Construction Motor Frames 254JP-256JP	—	P90533	P90533	P90533
10	Motor Bracket Capscrew for Above (4)	P13780	P13780	P13780	P13780
8	Motor Bracket — Motor Frames 284JP-286JP, 324JP-326JP	P53036	P53036	P53036	P53036
8	Motor Bracket — F Construction Motor Frames 284JP-286JP, 324JP-326JP	—	P90534	P90534	P90534
10	Motor Bracket Capscrew for Above (4)	P19490	P19490	P19490	P19490
13	Seal Kit 1 <sup>5</sup> / <sub>8</sub> " Shaft	186544	186543LF	186543LF	185225LF
11	Shaft Sleeve Kit 1 <sup>5</sup> / <sub>8</sub> " Shaft	185022	185021LF	185021LF	185021LF
12	Water Slinger 1 <sup>5</sup> / <sub>8</sub> " Shaft	P53720	P53720	P53720	P53720

— Factory recommended spare parts.

\*Includes Wear Ring

# 8 x 8 x 9<sup>1</sup>/<sub>2</sub> Pumps

ITEM NO.	DESCRIPTION	PUMP CONSTRUCTION			
		ALL IRON	BRONZE FITTED		
			STANDARD	W/WEAR RING	W/EPT SEAL

## PARTS COMMON TO BOTH TYPES

6	Impeller (State Diameter) 1 <sup>1</sup> / <sub>4</sub> " Shaft	P85548	P2000619	P2000619	P2000619
3	Impeller Capscrew 1 <sup>5</sup> / <sub>8</sub> " Shaft	P13800	P13800	P13800	P13800
4	Impeller Lockwasher 1 <sup>5</sup> / <sub>8</sub> " Shaft	J23875	J23875	J23875	J23875
5	Impeller Washer 1 <sup>5</sup> / <sub>8</sub> " Shaft	P46382	P51250	P51250	P51250
7	Impeller Key 1 <sup>5</sup> / <sub>8</sub> " Shaft	P49372	P49372	P49372	P49372
1	Volute	P85377	P85377	*P85516	P85377
	Wear Ring	—	—	P49144	—
	Volute Drain Plug 1/4" (5)	P39050	P39040	P39040	P39040
9	Volute Capscrew (12)	P03470	P03470	P03470	P03470
2	Volute Gasket	P48690	P48690	P48690	P48690

## PARTS FOR STANDARD SEAL CONSTRUCTION

8	Motor Bracket — Motor Frames 254JP-256JP	P77166	P77166	P77166	P77166
8	Motor Bracket — F Construction Motor Frames 254JP-256JP	—	P90529	P90529	P90529
10	Motor Bracket Capscrew for Above (4)	P13780	P13780	P13780	P13780
8	Motor Bracket — Motor Frames 284JP-286JP, 324JP-326JP	P53500	P53500	P53500	P53500
8	Motor Bracket — F Construction Motor Frames 284JP-286JP, 324JP-326JP	—	P90530	P90530	P90530
10	Motor Bracket Capscrew for Above (4)	P19490	P19490	P19490	P19490
13	Seal Kit 1 <sup>5</sup> / <sub>8</sub> " Shaft	186544	186543LF	186543LF	185225LF
11	Shaft Sleeve Kit 1 <sup>5</sup> / <sub>8</sub> " Shaft	185022	185021LF	185021LF	185021LF
12	Water Slinger 1 <sup>5</sup> / <sub>8</sub> " Shaft	P53720	P53720	P53720	P53720

— Factory recommended spare parts.

\*Includes Wear Ring

# 8 x 8 x 11 Pumps

ITEM NO.	DESCRIPTION	PUMP CONSTRUCTION			
		ALL IRON	BRONZE FITTED		
			STANDARD	W/WEAR RING	W/EPT SEAL

## PARTS COMMON TO BOTH TYPES

6	Impeller (State Diameter) 1 <sup>5</sup> / <sub>8</sub> " Shaft	P50978	P2000624	P2000624	P2000624
3	Impeller Capscrew 1 <sup>5</sup> / <sub>8</sub> " Shaft	P13800	P13800	P13800	P13800
4	Impeller Lockwasher 1 <sup>5</sup> / <sub>8</sub> " Shaft	J23875	J23875	J23875	J23875
5	Impeller Washer 1 <sup>5</sup> / <sub>8</sub> " Shaft	P46382	P51250	P51250	P51250
7	Impeller Key 1 <sup>5</sup> / <sub>8</sub> " Shaft	P49372	P49372	P49372	P49372
1	Volute	P85634	P85634	*P85642	P85634
	Wear Ring	—	—	P81949	—
	Volute Drain Plug (5)	P39050	P39040	P39040	P39040
9	Volute Capscrew (16)	P13780	P13780	P13780	P13780
2	Volute Gasket	P80765	P80765	P80765	P80765

## PARTS FOR STANDARD SEAL CONSTRUCTION

8	Motor Bracket — Motor Frames 254JP-256JP	P53032	P53032	P53032	P53032
8	Motor Bracket — F Construction Motor Frames 254JP-256JP	—	P90533	P90533	P90533
10	Motor Bracket Capscrew for Above (4)	P13780	P13780	P13780	P13780
8	Motor Bracket — Motor Frames 284JP-286JP, 324JP-326JP	P53036	P53036	P53036	P53036
8	Motor Bracket — F Construction Motor Frames 284JP-286JP, 324JP-326JP	—	P90534	P90534	P90534
10	Motor Bracket Capscrew for Above (4)	P19490	P19490	P19490	P19490
13	Seal Kit 1 <sup>5</sup> / <sub>8</sub> " Shaft	186544	186543LF	186543LF	185225LF
11	Shaft Sleeve Kit 1 <sup>5</sup> / <sub>8</sub> " Shaft	185022	185021LF	185021LF	185021LF
12	Water Slinger 1 <sup>5</sup> / <sub>8</sub> " Shaft	P53720	P53720	P53720	P53720

— Factory recommended spare parts.

\*Includes Wear Ring

# Xylem |'zīləm|

- 1) The tissue in plants that brings water upward from the roots;
- 2) a leading global water technology company.

We're 12,700 people unified in a common purpose: creating innovative solutions to meet our world's water needs. Developing new technologies that will improve the way water is used, conserved, and re-used in the future is central to our work. We move, treat, analyze, and return water to the environment, and we help people use water efficiently, in their homes, buildings, factories and farms. In more than 150 countries, we have strong, long-standing relationships with customers who know us for our powerful combination of leading product brands and applications expertise, backed by a legacy of innovation.

**For more information on how Xylem can help you, go to [www.xyleminc.com](http://www.xyleminc.com)**



Xylem Inc.  
8200 N. Austin Avenue  
Morton Grove, Illinois 60053  
Phone: (847) 966-3700  
Fax: (847) 965-8379  
[www.marlowpumps.com](http://www.marlowpumps.com)

Goulds is a registered trademark of Goulds Pumps, Inc. and is used under license.  
© 2013 Xylem Inc. MA-580-PL November 2010